

- REMARK: 1. ACCEPTS $\phi 0.5 \sim \phi 1.07$ MATING PIN
(允許 $\phi 0.5 \sim \phi 1.07$ 公針配合)
2. RoHS COMPLIANT
(符合 RoHS)

| ISS SYMBOL | REVISIONS | DESCRIPTION \ DATE |
|------------|-----------|------------------------------------|
| A2 | | 新增 $\phi 9.42 \pm 0.07$ \ 08/07/08 |

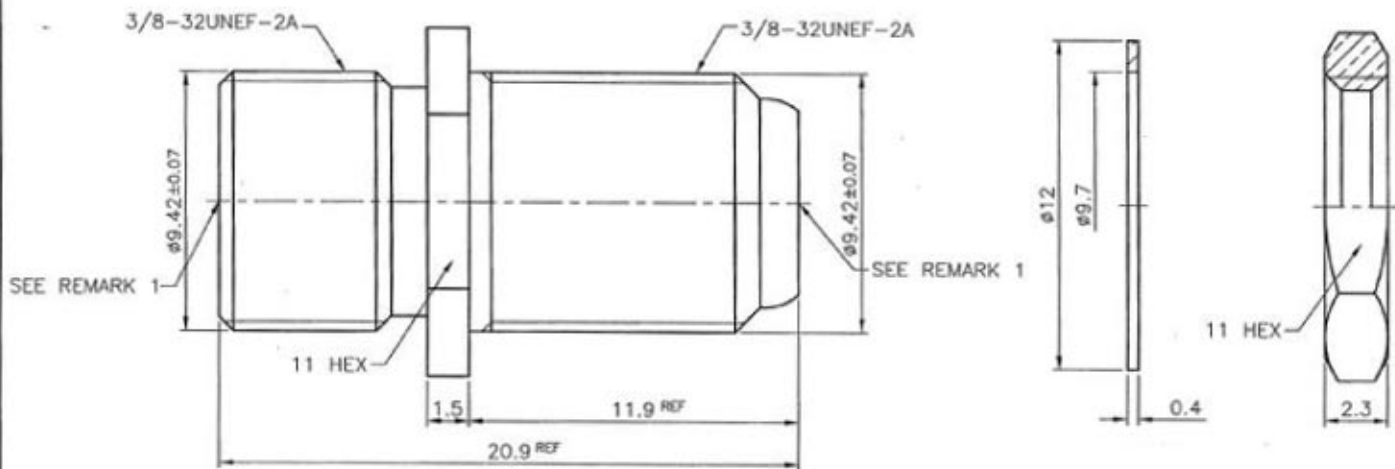

NOTES: FINISH (PLATING THICKNESS IN MICRO-INCHES)

1. BRASS PER QQ-B-626
2. NICKEL PL 70 MIN THICK OVER COPPER STRIKE
3. BRASS JIS H 3100, C 2680
4. BRIGHT TIN PL 100 MIN THICK OVER COPPER STRIKE

| | | | | | DIMENSIONS ARE IN MILLIMETERS | | PART NO. | | | | |
|-------------|-------------|----------|--------|------|---|----------|--------------|----------|---------------------------------|----------|---|
| 1 | 2 | 3 | 4 | 5 | UNLESS OTHERWISE SPECIFIED TOLERANCES (一般公差) 0.5~6 = ± 0.2 >6~30 = ± 0.4 >30~120 = ± 0.6 >120~315 = ± 1 >315~1000 = ± 1.5 ANGLES(角度) = $\pm 5^\circ$ | | APPROVED | DATE | | | |
| NUT | STEEL | NOTE 2 | | | | | <i>Kouly</i> | 08/07/08 | | | |
| WASHER | SS41 | NOTE 2 | | | | | CHECKED | DATE | | | |
| CONTACT PIN | NOTE 3 | NOTE 4 | | | | | <i>Kouly</i> | 08/07/08 | | | |
| INSULATOR | P.P. | NATURAL | | | | | DRAWN | DATE | | | |
| BODY | NOTE 1 | NOTE 2 | | | <i>Alien</i> | 08/07/08 | | | | | |
| NO. | DESCRIPTION | MATERIAL | FINISH | Q'TY | DRAWING NO. | SCALE | 5/1 | ISSUE | A2 | FILE NO. | Z:\IND\7278\AS\700\000\7278AS700CL000B-A2 |
| | | | | | | | TITILE | | F JACK TO BULKHEAD JACK ADAPTOR | | |
| | | | | | | | DRAWING NO. | | 7278AS700CL000B | | |